



P R I M E R E S I D E N T I A L

P R E S E N T S

St. Johns Road, Loughton



elliott **E | J** james

PRIME RESIDENTIAL

St. Johns Road, Loughton



Nestled on the prestigious St. Johns Road in Loughton, this beautiful detached family home offers an exceptional living experience. With five generously sized bedrooms and four well-appointed bathrooms, this property is perfect for families seeking both space and comfort. This home is offered to the market CHAIN FREE.

As you enter, you will be greeted by an abundance of natural light that flows through the well-proportioned rooms, creating a warm and inviting atmosphere. The three reception rooms provide ample space for relaxation and entertainment, making it easy to host gatherings or enjoy quiet family evenings.

The property boasts a very large drive, ensuring plenty of parking for residents and guests alike. The expansive garden space is a true highlight, offering a wonderful outdoor area for children to play, gardening enthusiasts to indulge their passion, or simply for enjoying the fresh air in a tranquil setting.

This home is not just a place to live; it is a sanctuary that combines elegance with practicality, making it an ideal choice for those looking to settle in a sought-after location. With its impressive features and prime position, this property is a rare find and is sure to attract considerable interest. Don't miss the opportunity to make this stunning family home your own.

Please contact us on 0208 0165 333 to arrange a viewing for your next home!



The property market has always interested me and seeing the reaction when someone finds their next home is something that really drives me to go above and beyond. I have a pride in my local area having grown up here, this also allowed me to grow a strong knowledge of the local community. With experience in the role already I look to provide a service to both buyers and sellers in which communication and transparency are key. I am incredibly proud to be a part of such a brilliant team dedicated to providing bespoke service to such a beautiful community.



An unrestricted fully immersive walkthrough is available in our E|J Business Lounge by arrangement. Restricted walkthrough access is available on our website through your smartphone or desktop.

Daniel Thomas
contact@ejpr.co.uk
0208 0165 333

N
E
E
D

T
O

K
N
O
W

Sqft 4155.00 sq ft	Type House - Detached	Style 1950's
Bedrooms 5	Receptions 3	Bathrooms 4
Tenure Freehold	Local Authority Epping Forest	Tax Band G

PLANS

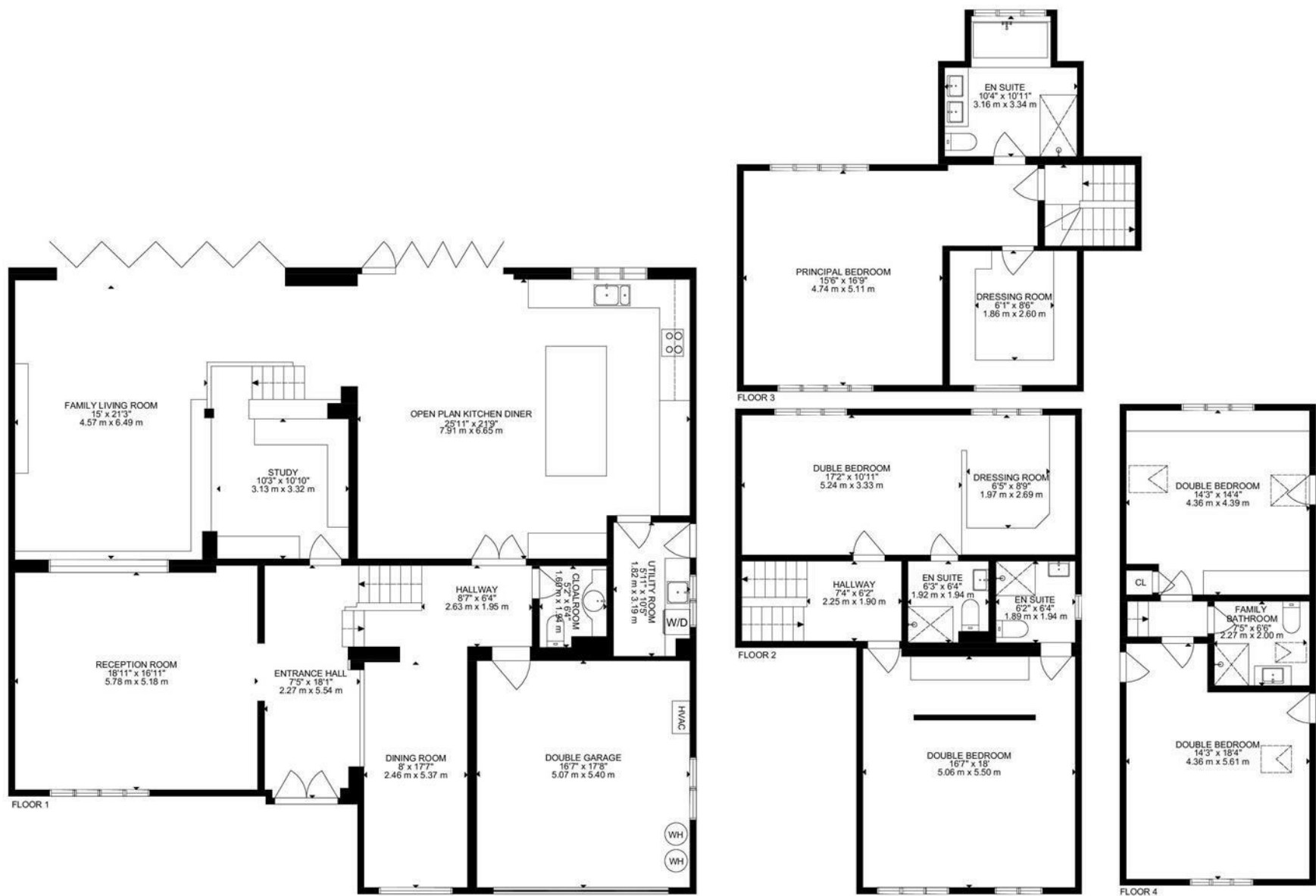

GROSS INTERNAL AREA
 FLOOR 1: 2110 SQ FT, 196 m², FLOOR 2: 840 SQ FT, 78 m², FLOOR 3: 635 SQ FT, 59 m², FLOOR 4: 570 SQ FT, 53 m²
 EXCLUDED AREAS: GARAGE: 321 SQ FT, 29 m²
 TOTAL: 4155 SQ FT, 386 m²
 SIZE AND DIMENSIONS ARE APPROXIMATE, ACTUAL MAY VARY



MAP & EPC

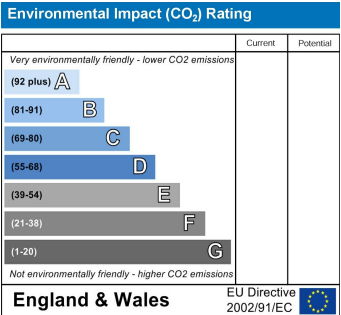
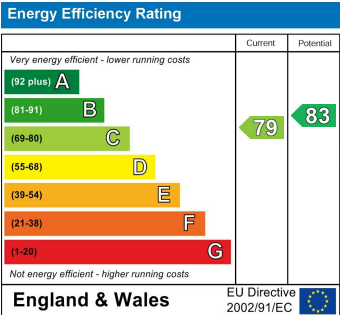
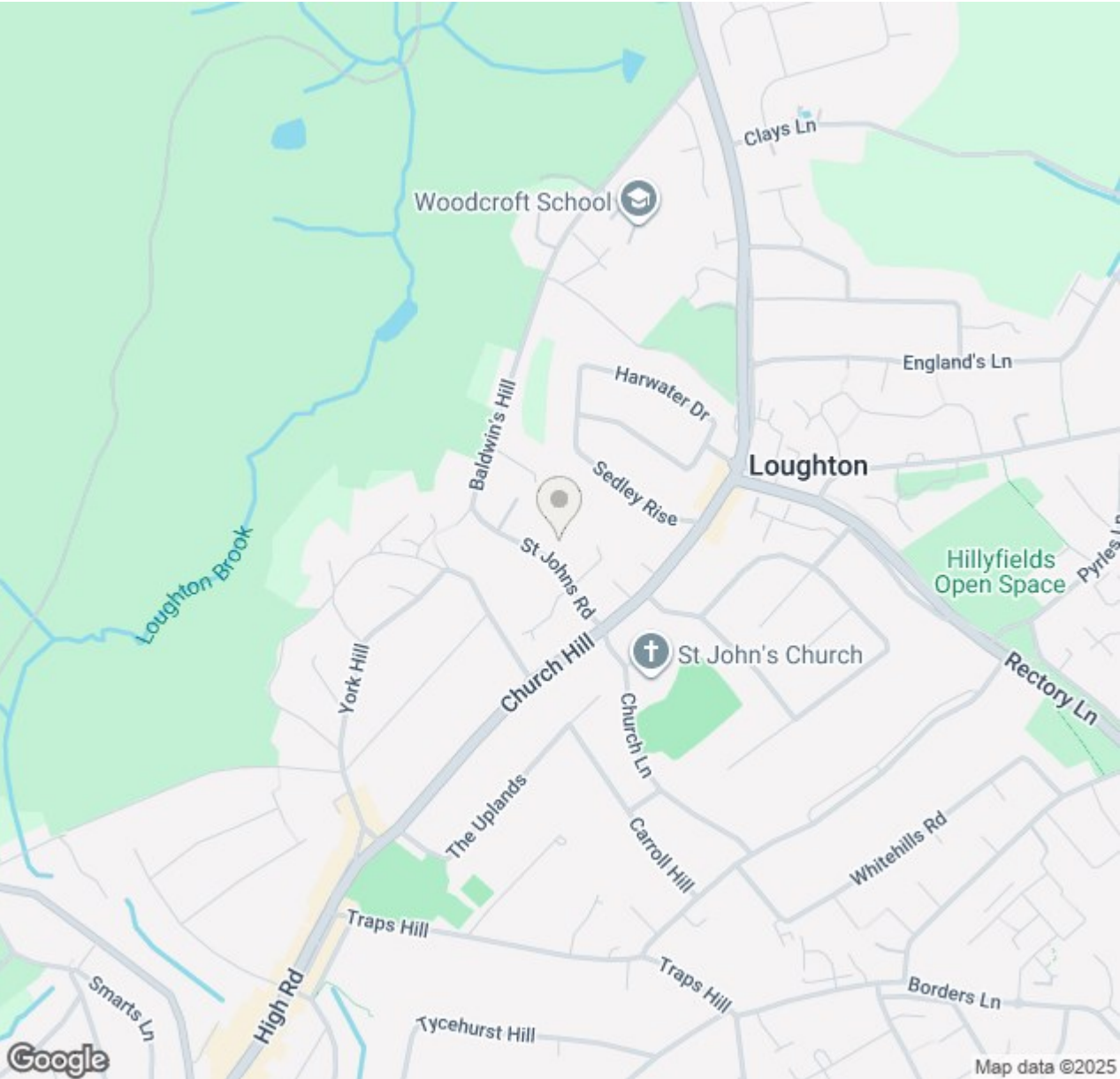

elliott  james

165 | High Road | Loughton | IG10 4LF

Contact Us : 0208 0165 333 | contact@ejpr.co.uk

Follow us on social media | Search 'ejpr165'



These particulars have been prepared with approximate measurements in good faith by Elliott James – Prime Residential with the assistance of the vendor. The intention is to provide a fair and accurate guide to the property. These details do not constitute or form any part of an offer or contract. All interested parties must verify for themselves the accuracy of the information provided. The structural condition of the property or the condition of the heating, plumbing or electrical installations or any appliances have not been checked or tested and suitable investigations by interested parties should be conducted prior to purchase.